



THE GORE
LONDON

STARHOTELS®
COLLEZIONE



Destination

London shows visitors a new side of itself every time. Don't miss Big Ben and the Houses of Parliament, Westminster Abbey and St Paul's Cathedral, Tower Bridge, the Tower of London and, of course, Buckingham Palace.

London is also home to many world-class museums and art galleries, including the British Museum, the National Gallery, Tate Modern and the Victoria and Albert Museum.



190 Queen's Gate, Kensington
London, SW7 5EX
T + 44 (0) 20 7584 6601
reservations.thegore@starhotels.com
gorehotel.com

Location

The Gore is situated between Knightsbridge and Kensington, overlooking Queen's Gate that leads up to Hyde Park.

The hotel is just around the corner from the Royal Albert Hall and a short walk from Kensington Palace, while the shopping Mecca of Knightsbridge, including Harrods and Harvey Nichols, is just a short stroll away.

It is also a five-minute walk from Kensington High Street and the museums of South Kensington, while a short underground journey will take you to the heart of the West End.

Distances

Railway Station: Victoria Station 1 mi/2,6 km

Airport: Heathrow 14 mi /23 km
Stansted 39mi/63 km
Gatwick 29 mi/47 km

Underground: Gloucester Road 0.4 mi/0,8 km
South Kensington 0.6 mi/1 km

THE GORE
LONDON



*A quintessentially British
hotel since 1892*

Opened in 1892, in an enviable location among the high-life hotspots of Kensington and Knightsbridge, each of the six floors is a treasure trove of period details and hand-picked piece.

Guests can immerse in the same atmosphere that has attracted artists and aristocrats, and live among the settings that have featured in many films.



Key features

- Founded in 1892, The Gore is a symbol of the history of British hospitality.
- The perfect South Kensington base for discovering the many attractions London has to offer.
- A historic Victorian building with antique furniture from the 18th and 19th centuries.
- The Junior Suites are named after some of the hotel's most prominent guests, including Dame Nellie, Judy Garland and Lady Blessington.
- In 1968, Bar 190 witnessed a fundamental chapter in the history of rock: the Rolling Stones' Beggars Banquet album launch.
- 190 Queen's Gate offers a sublime gastronomic experience, interpreting great British classics with a contemporary touch and exquisite French flair.





Sophisticated rooms

All the lavishly appointed rooms and suites are individually furnished, with beautiful antiques, period photos and ornately decorated beds creating a distinctive, sophisticated atmosphere that makes each one truly unique.

Number of rooms: 50

- 1 Tudor Suite
- 7 Junior Suite
- 1 Judy Garland Junior Suite
- 10 Deluxe Double
- 2 Superior Twin Room
- 12 Superior Double
- 15 Classic Double
- 2 Classic Single





Dining

The Gore is just around the corner from the Royal Albert Hall which makes it the perfect place for pre- and post-theatre dining.

190 Queen's Gate offers a sublime gastronomic experience, interpreting great British classics with a contemporary touch and exquisite French flair. The adjacent Bar 190, which hosted the Rolling Stones' Beggars Banquet album launch, has a glamorous atmosphere, and serves unconventional cocktails.



Meeting & Events

For formal board meetings or cocktail parties, wedding receptions or gala dinners, formal lunches or film shoots, the 3 prestigious solutions at The Gore can accommodate up to 50 guests in a beautiful setting where 19th-century elegance and 21st-century facilities come together perfectly.

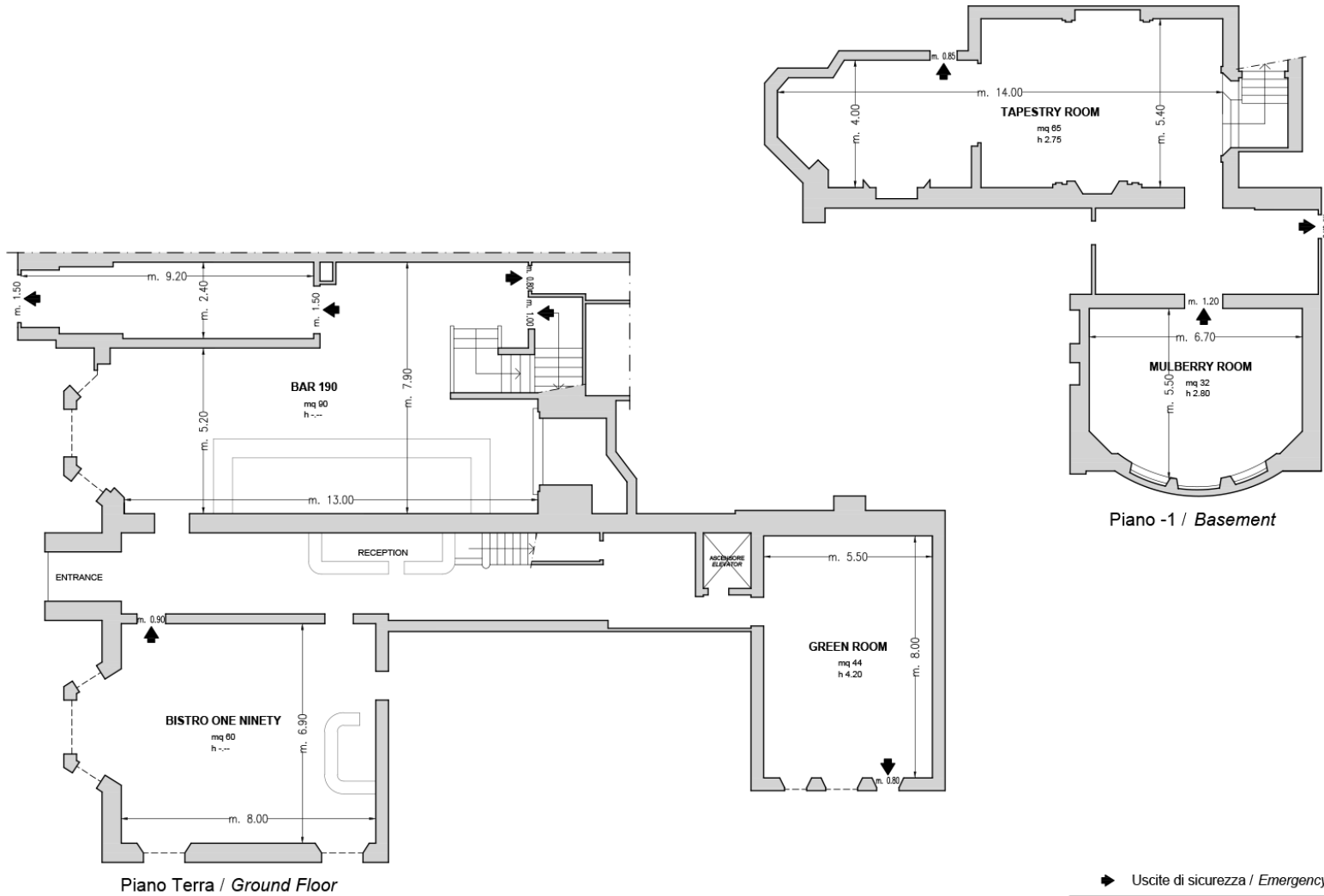

- ▶ Uscite di sicurezza / Emergency Exits
- - - - Finestre / Windows
- ▣ Colonne / Columns

Meeting rooms	Area mq / ft.	L x W mt. / ft.	Height mt. / ft.	Theatre	Class room	Conference table/ U-shape	Cabaret style^	Cocktail reception	Banquet
Library °	44 474	8,00x5,50 26,25x18,05	4,2 13,78	24	10	22/14	14	34-40	30
Mulberry Room °	32 344	6,70x5,50 21,98x18,05	2,8 9,19	20	10	16/14	10	30	20
Tapestry Room °	65 700	14,00x5,40 45,93x17,72	2,8 9,19	50	20	30/24	32	120	60
Mulberry & Tapestry °	97 1044	6,70x5,50+ 14,00x5,40 21,98x18,05x 45,93x17,72	2,8 9,19	-	-	22/-	-	150	-
190 Queen's Gate Restaurant	60 646	8,00x6,90 26,25x22,64	2,8 9,19	-	-	-	-	60	-
Bar 190 °	90 969	13,00x7,90 42,65x25,92	2,8 9,19	-	-	-	-	150	-

° Daylight

^ Cabaret style: Size tables diameter 150 cm



THE GORE

LONDON

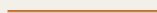

STARHOTELS[®]

COLLEZIONE

gorehotel.com